

KingBright

Dimensions and Internal Circuit Diagram

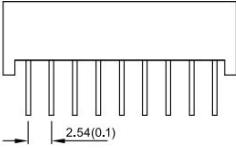

Recommended PCB Layout

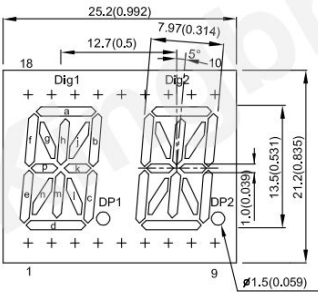
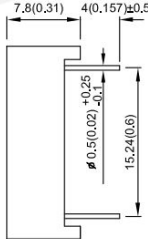
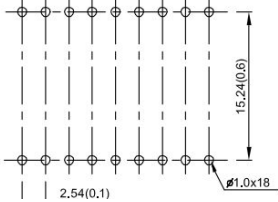

Dig 1 : 16

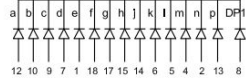

Dig 2 : 11

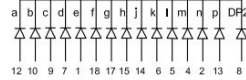

Lite-On

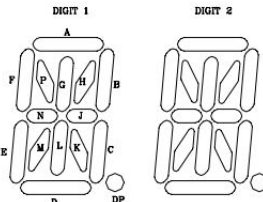
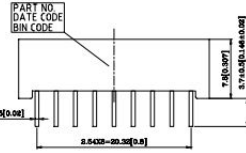
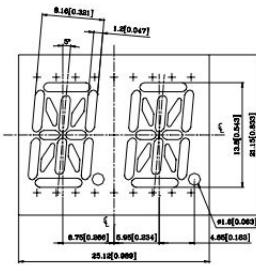

NOTES: All dimensions are in millimeters. Tolerances are  $\pm 0.25$ -mm (0.01") unless otherwise noted.

INTERNAL CIRCUIT DIAGRAM

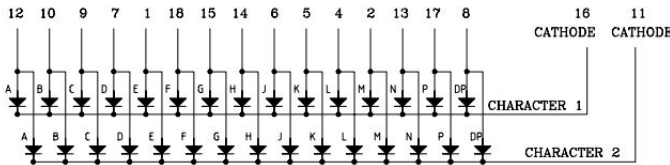

KingBright

### ISO Internal Circuit Diagram

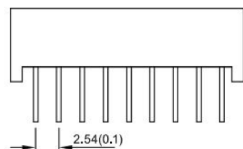
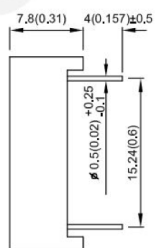
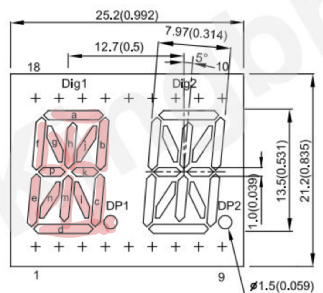

### Recommended PCB Layout

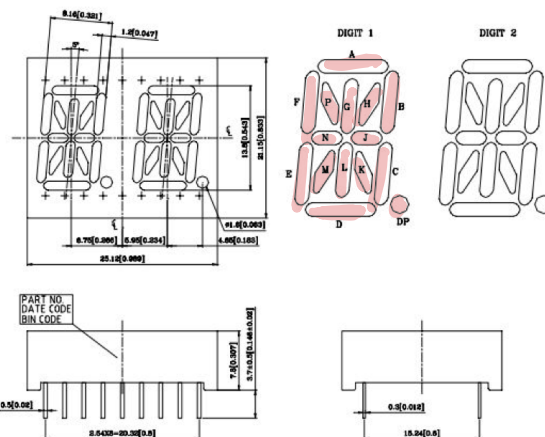
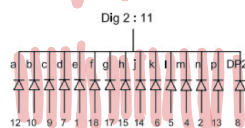
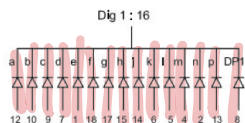
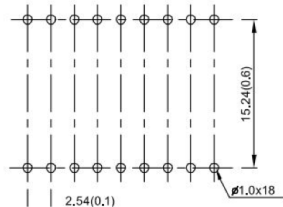

NOTES: All dimensions are in millimeters. Tolerances are  $\pm 0.25\text{-mm}$  (0.01") unless otherwise noted.

### INTERNAL CIRCUIT DIAGRAM

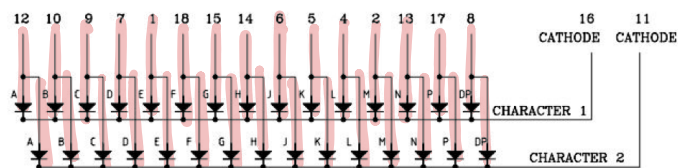

16	11
CATHODE	CATHODE

### CHARACTER 1

## CHARACTER 2